

REVISION RECORD				
REV	ECO	DESCRIPTION	DRFT	CHKD

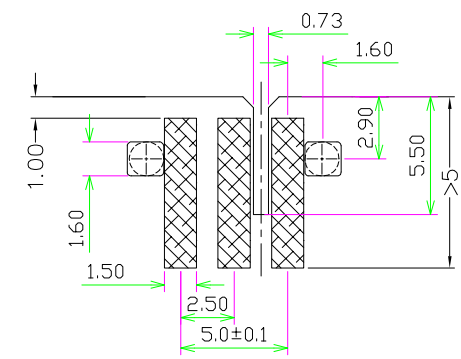
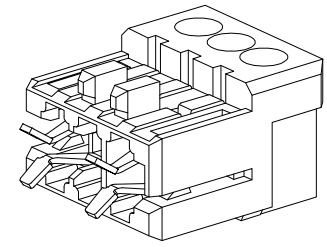
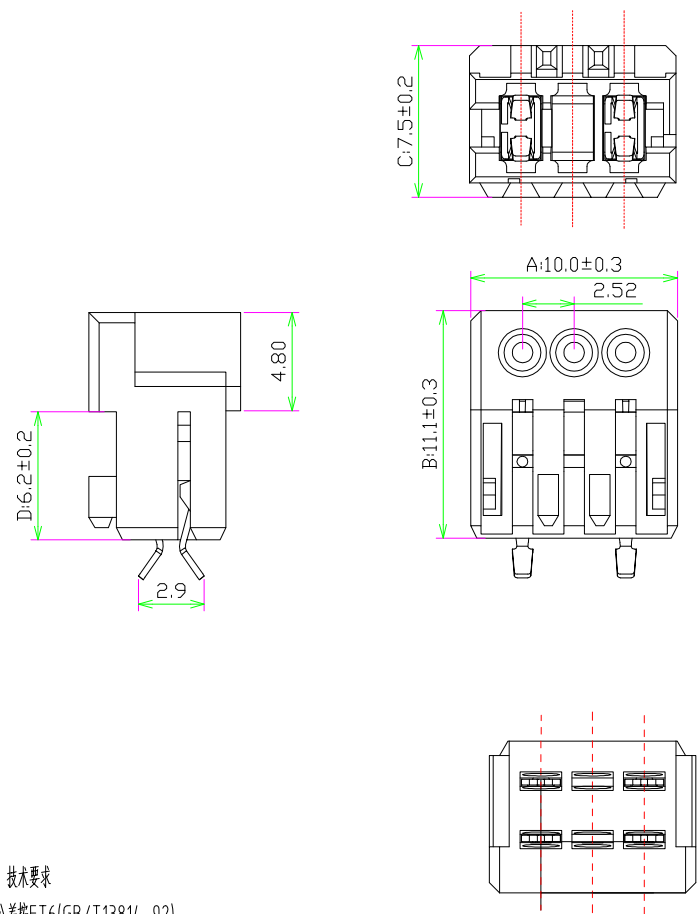

P.C.Board layout

技术要求

1. 未注公差按 FT6 (GB/T13814-92)。
2. 制作表面光洁, 无伤痕和毛刺。
3. 额定电流 Current Rating: 3A AC DC。
4. 额定电压 Voltage Rating: 32V AC DC。
5. 接触电阻 Contact Resistance:  $10m\Omega$  Max。
6. 绝缘电阻 Insulation Resistance:  $1000m\Omega$  Min。
7. 工作温度 Operating Temperature:  $-40^{\circ}C$  to  $+120^{\circ}C$
8. 材料 Material:
  - 塑件 (Housing): Nylon66 UL94V-0
  - 端子 (Terminal): Phosphor bronze, Tin-plated
9. 适合导线范围: AWG24#。
10. GWT:  $750^{\circ}C$  IEC-60335-1

DETACHED LISTS	MM (INCH)		DFTO: 吴善群	DATE: 2022.6.20	青岛贝速特电子有限公司 BSET ELECTRONICS CO.,LTD 刺破式连接器 RAST TYPE TERMINAL
	TOLERANCES EXCEPT AS NOTED		CHKD:	DATE:	
	MM	±	APPVL:	DATE:	
	.0 ± 0.20	±	MATERIAL: Housing: Nylon66 UL94V-0 Terminal: Phosphor, Tin-plated		
	.00 ± 0.15	±	QT'Y: 1000PCS	/PART NO. BST7238-003-062	
.000 ± 0.075	±	FINISH:	SCALE: 1:1	DO NOT SCALE DRAWING	SHEET 1 OF 1
ANGLES ± 0.5°					
THIRD ANGLE PROJECTION					